

BEFORE INSTALLING YOUR CAT FLAP PLEASE READ THE FOLLOWING STEP-BY-STEP INSTRUCTIONS CAREFULLY.

TOOLS REQUIRED

- Pencil
- Ruler
- Jig or Keyhole Saw
- Drill
- Set Square
- Screwdriver
- Tape measure
- Glue

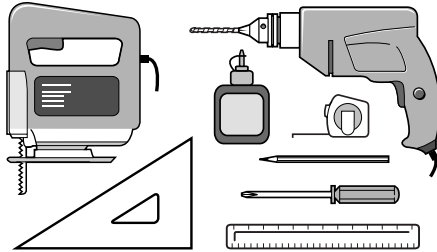

MEASUREMENT AND MARKING

Measure the belly height of your cat. This is usually 100-150mm (4-6") (Fig. 1).

Mark this measurement on the outside of your door and draw a straight horizontal line 168mm (6¹/₂") (Fig. 2).

FIG. 1

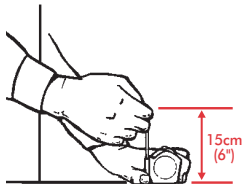
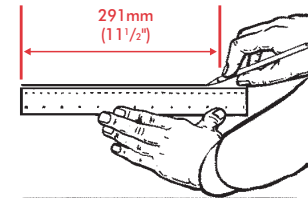

FIG. 2



CUTTING A HOLE FOR YOUR CAT FLAP

a) In Wood

Using the horizontal line as the starting point, draw a square 168mm wide (6¹/₂") x 175mm high (6³/₄") (Fig 3).

Drill holes at each corner (Fig. 4).

Cut along the lines using a jig saw (Fig. 5).

Smooth out the rough edges (Fig. 6).

FIG. 3

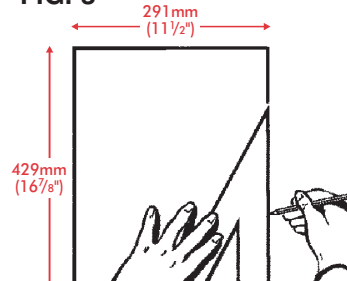

FIG. 4

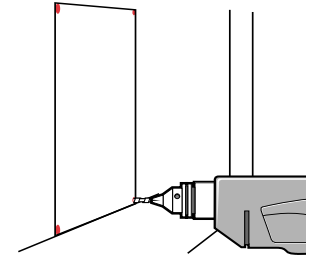

FIG. 5

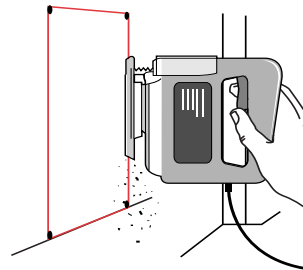
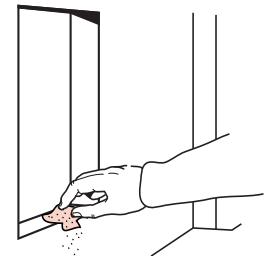

FIG. 6



b) In Glass

Using the horizontal line as the base, cut a circular hole to a diameter of 212mm (8^{3/8}") (Fig. 7).

It is not possible to cut holes in toughened glass or double glazed units except at the time of manufacture.

400 Series will only operate in double glazing if a plastic spacer bar is used. If a metal spacer is used it must be left unjoined.

Cutting holes in glass can be hazardous. We advise you to consult your local glazier.

c) In Metal

Cat Flaps 300 & 500 Series

Follow the instructions for "Cutting a Hole for your Cat Flap in Wood".

Cat Flaps 400 Series

The cat flap will not operate if fitted to a door containing metal e.g. uPVC coated metal doors, metal skin doors or security doors. The cat flap must be isolated from the metal in a wood frame.

Using the horizontal line, draw a square with minimum dimensions of 306mm x 306mm 12^{1/4}" x 12^{1/4}" (Fig. 8).

Cut along the lines with a jigsaw.

FIG. 7

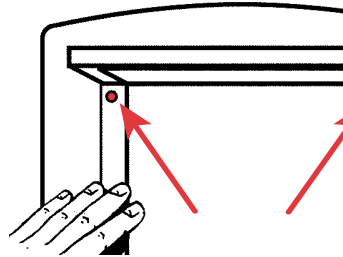
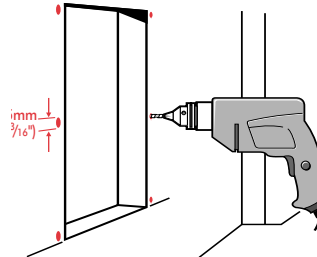

FIG. 8



Fit a wood frame to the hole with internal dimensions of 168mm wide (6^{1/2}" x 175mm high (6^{3/4}" (Fig. 9).

d) In Walls

Follow the instructions for "Cutting a Hole for your Cat Flap in Wood".

Tunnels (Optional)

The cat flap is designed to fit any depth of hole. It is recommended that the tunnels be glued on to the frame (Fig. 10). Simply attach tunnels to the required depth.

To purchase additional tunnels contact Staywell Consumer Services.

FIG. 9

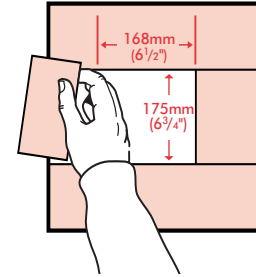
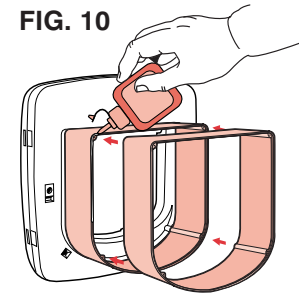

FIG. 10



FITTING YOUR CAT FLAP

Your Staywell cat flap is fitted with the red 4 way lock on the inside of your door.

Place the cat flap in the hole and mark screw holes in the outside cover in pencil. (Fig. 11).

Remove the cat flap and drill the holes with a 4.5mm (3/16") drill bit (Fig. 12).

FIG. 11

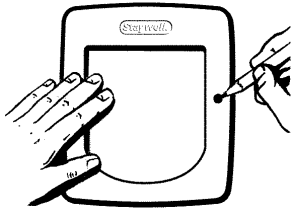
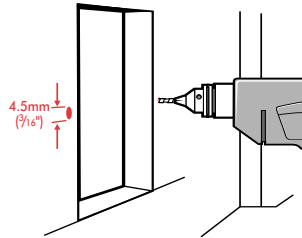

FIG. 12



Screw into place and if needed cut the screws down to size and file to ensure no sharp edges.

Cover the screw holes with the blanking plugs supplied to ensure a neat finish (Fig. 13).

Push fit the 4-way locking handle into place (Fig. 13).

Your Staywell cat flap is now ready to use.

FIG. 13

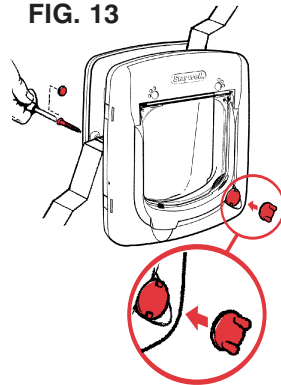

Magnetically Operated Cat Flaps 400 Series

The fixed tunnel is an integral part of the mechanism and must not be cut or damaged, as it will effect the operation of the latching mechanism (Fig. 14).

Operates by magnetism and requires no batteries.

FIG. 14

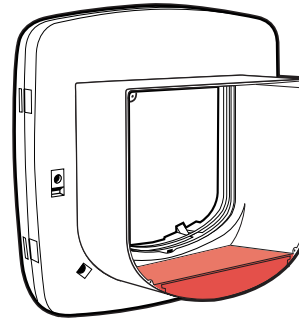

USING YOUR 4-WAY LOCKING SYSTEM

The 4-way lock allows you to control your cat's access in and out of your home.

In only (Fig. 15)

Out only (Fig. 16)

In or Out (Fig. 17)

Fully locked (Fig. 18)

FIG. 15

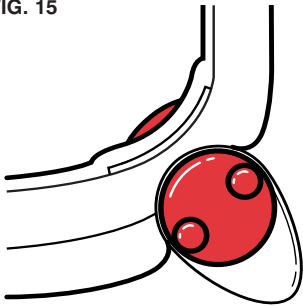

FIG. 16

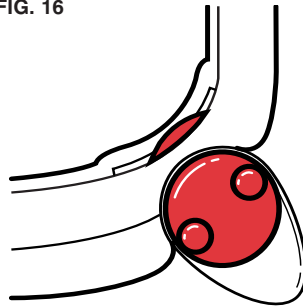

FIG. 17

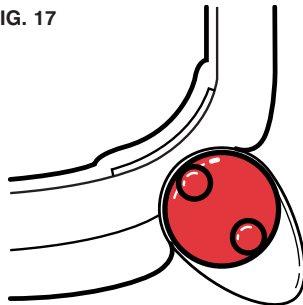
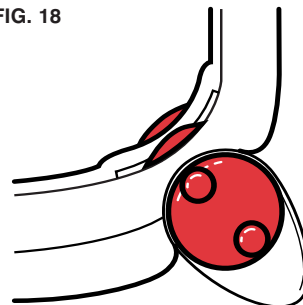

FIG. 18



POWERING THE INFRA RED UNIT (500 Series only)

Remove the hinge cover by pushing in the direction of the arrow (Fig. 19).

Place 4 x AA 1.5V Alkaline Long Life batteries in position (Fig. 20).

Batteries should be replaced every 12 months. Do not use rechargeable batteries

After you have powered the cat flap it emits a low tone bleep indicating the cat flap is ready for programming. In addition to the bleep the red LED will flash.

FIG. 19

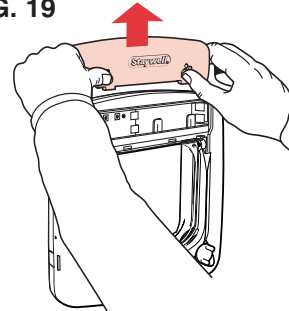
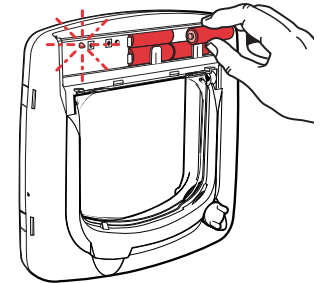

FIG. 20



POWERING THE KEY

Open the collar key by twisting a coin between the two flanges (Fig. 21).

Place 2 x SR44, LR44 or D357 coin cells into the collar key (Fig. 22).

Clip the two halves of the key together firmly (Fig. 23).

Coin cells should be replaced every 12 months.

FIG. 21



FIG. 22

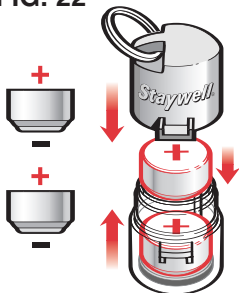
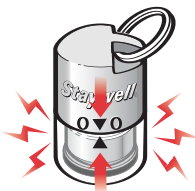

FIG. 23



ATTACHING THE KEY

The key must be attached to the collar so that it hangs forwards (Fig. 24).

FIG. 24



ADAPTOR MAINS POWER OPTIONAL

Plug adaptor into a household electric socket (Fig. 25).

Place the jack plug into the socket at the side of the cat flap (Fig. 26).

FIG. 25

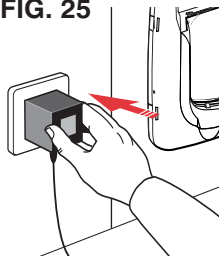
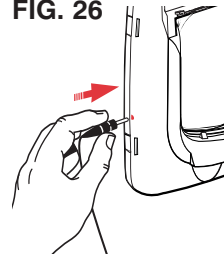

FIG. 26



PROGRAMMING YOUR CAT FLAP

After powering the cat flap and the collar key, approach the flap with the key. The red LED will stop flashing and the unit will emit a high pitched beep. Your cat flap is now programmed to recognise the collar key (Fig. 27).

If you have more than one cat, you will need to purchase collar keys of the same colour code.

The colour codes available are:
Green, Yellow, Blue and Pink.

If your cat loses a collar key, you must purchase a collar key of the same colour or reprogramme the cat flap with another colour coded key.

To reprogramme the cat flap, please disconnect the batteries for approximately one minute.

The latch will not relock until the cat key is out of range of the door.

FIG. 27

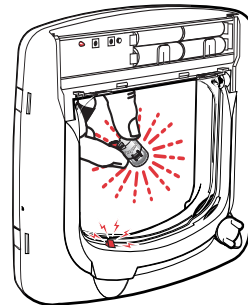

TO SET RE-LATCH TIME

The latch on your cat flap has been factory set to re-latch after 2 seconds. The time can be set between 2 and 20 seconds. The period that you set the re-latch time will depend on your own cat and your personal preference.

Remove the hinge cover. Press the manual button (Fig. 28), the LED will flash and the latch will open. Press the timer button within 2 seconds (Fig. 29). Each press of the timer button will increase the re-latch time by one second (Fig. 29). Each time the button is pressed the cat flap will emit a high bleep. Once the time out reaches 20 seconds the timer reverts to 2 seconds and emits a low bleep.

The cat flap will automatically return to manual mode after 2 seconds or by pressing the manual button (Fig. 28). Press the manual button again to return to automatic mode and the LED will flash and the latch will re-lock.

FIG. 28

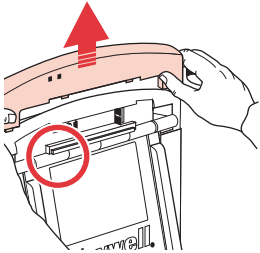
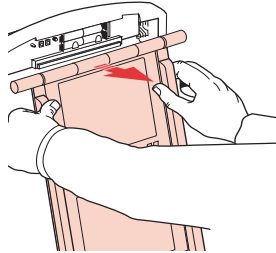

FIG. 29



MANUAL OPERATION

If you do not wish to use the electronic latch the cat flap can be placed in manual mode.

Remove the hinge cover. Press the manual button once (Fig. 30) and the latch will unlock and the LED flashes.

To place the cat flap in automatic mode press the manual button. The latch will lock and the LED flashes.

Please note that manual mode can only be activated when the cat flap is powered and programmed.

FIG. 30

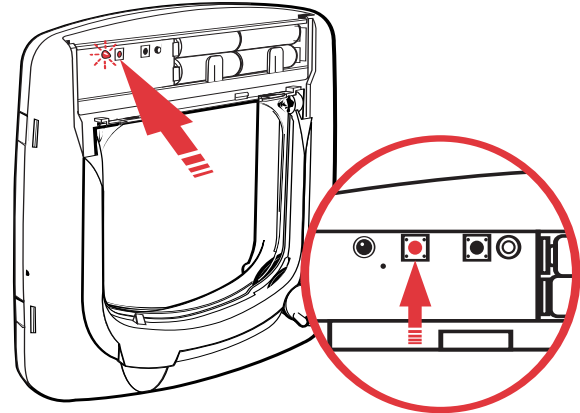

LOW BATTERY POWER

When the batteries are starting to run low the cat flap will warn you by emitting a bleep every 2 minutes. The LED will flash continually.

Remove the old batteries and insert the new batteries (Fig. 31). Your cat flap will need reprogramming. Follow instructions for "Programming Your Cat Flap".

FIG. 31

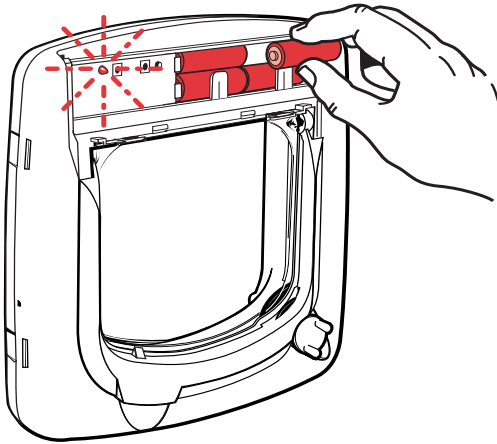

LOW COLLAR KEY BATTERY POWER

As the power in your collar key batteries runs low you will notice a loss of range as your cat approaches the door. Eventually the battery power will become so low that the cat door will not open. To restore power, replace the two batteries in the collar key and refer to "Powering the Key".

CLEANING YOUR CAT FLAP

Your cat flap is constructed in the highest quality material with a toughened flap and has been designed to last for many years. To maintain its appearance, occasional wiping with a damp cloth is all that is necessary.

CLEANING THE INFRA RED LENS

For best performance wipe the lens clean every 4 weeks with a soft cloth (see red circle on Fig. 32).

BROKEN AND DAMAGED PARTS

In the event of a broken or damaged part, your cat flap has been designed to ensure that you can replace all parts. In particular, the flap can be simply replaced by removing the removable hinge cover and inserting a new flap (Fig. 32).

To replace any other part, please remove the red handle before dismantling the cat flap (Fig. 33).

FIG. 32

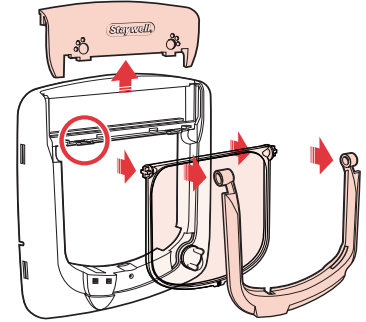
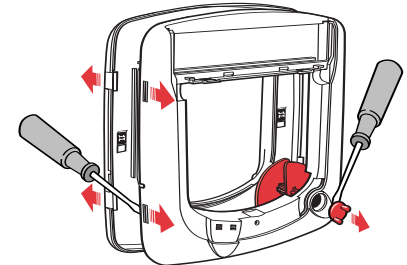

FIG. 33



TRAINING YOUR CAT TO USE YOUR STAYWELL CAT FLAP

Most cats will learn to use your cat flap almost at once but there are a few which may be a little nervous at first. The following tips, provided by a well-known consultant in animal behaviour, will help your pet to take full advantage of the outdoor freedom and indoor comfort – which you want for your cat – and which your new pet door provides.

The most important rule is to be patient with your cat. Don't be in a hurry. Let your animal work out for itself that it can go in and out of doors. Don't force it through the flap or it may become frightened.

Many cat owners install pet doors when they move house. If this applies to you, make sure your animal is familiar with his or her surroundings before you fit the pet door. Take it on supervised trips outdoors on a leash, and make sure it also feels secure and comfortable in its new indoor environment. Cats can develop long-lasting fears in unfamiliar surroundings.



Once you have installed your pet door leave it propped open for some time. You can do this with a piece of wood or by attaching a clothes peg to the top of one side of the flap, while it is open. Make sure that the fixing is secure so that the flaps cannot fall down accidentally. Let your cat become familiar with it and go in and out freely.

Establish a motive for your cat to use the door. The obvious one is food. First feed the cat near the door, inside and then near the door outside. Repeat as often as you need to. Most cats, especially kittens, also have a strong urge for freedom, perhaps to hunt. Cats are also social creatures – they enjoy the company of other cats. This can be another reason for them to explore outside.

It is a good idea not to use the lock for your pet door until your cat is thoroughly familiar with using the door. Your cat may become confused as to why you have installed it.

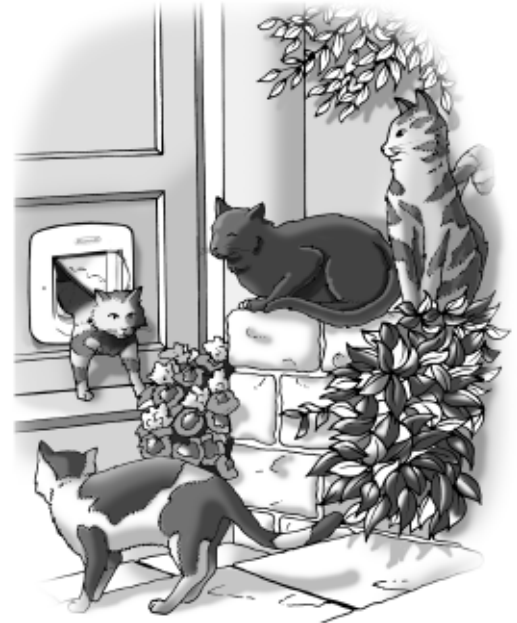

PET DOORS OF THE PAST

Did you know that pet doors are not a twentieth century invention? Admittedly, the pet doors of our forefathers were not the sophisticated draught and rain-proof devices that Staywell provide today, but even in the Middle Ages, pet owners realised that their animals needed both indoor comfort and outdoor freedom.

One amusing story concerns the English scientist Isaac Newton. He was a great cat lover and in order that his cat could sleep in the warmth of his barn, he cut a small opening in the door, so that she could come and go freely. Soon the cat had kittens and Newton cut a smaller hole in the barn door for the kittens to use. It is possible that Newton may have been conducting an experiment on cat behaviour, but it is more likely that he simply had not realised that the kittens could have easily used their mother's 'pet door'.



This product is designed for the convenience of you and your pet and has built in security features to reduce the risk of other animals entering your home. However, as with all pet doors, it is not possible to fully guarantee the exclusion of all other animals in all circumstances. Reilor Limited will not accept liability for any damage or inconvenience caused by any unwanted animals who may gain access to your home.

E.U./U.K.

Reilor Ltd.,
Preston PR2 5AP, England
Tel: +44 (0) 870 753 9898

U.S.A.

Reilor Inc
Runnemede NJ 08078, USA
Tel: +1 856 939 5155

REST OF THE WORLD

Please contact your local distributor
for warranty claims and parts
replacement service.

Visit our web site at www.staywell.co.uk

Email: info@reilor.com